

# 830453 [TA Elimination Coupler Kit]

Instruction Guide

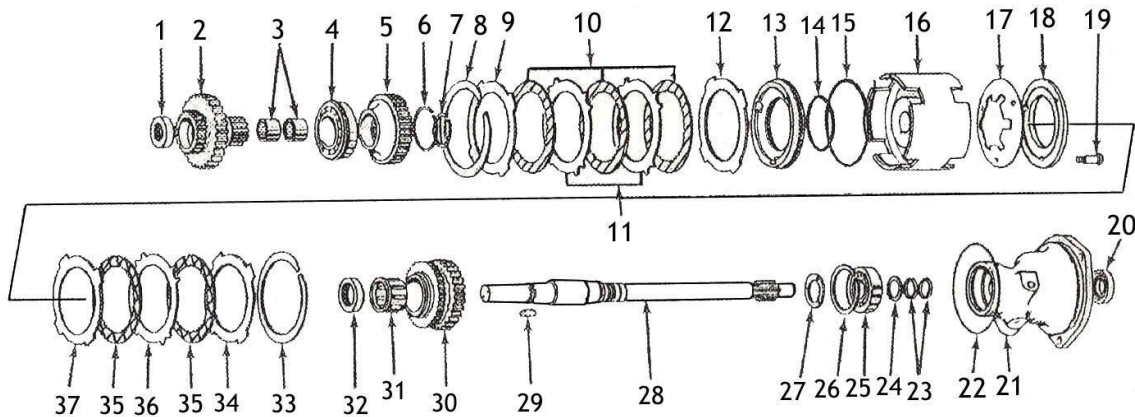

**Not for forward-reverse transmissions (2 speed powershift only)**

- |                      |                          |                    |                          |
|----------------------|--------------------------|--------------------|--------------------------|
| 1. Needle Bearing    | 11. Separator Plates (2) | 21. Housing        | 31. Sprag Clutch         |
| 2. Direct Drive      | 12. Piston Back Plate    | 22. O-Ring         | 32. Oil Seal             |
| 3. Needle Bearings   | 13. Direct Drive Piston  | 23. Seal Rings     | 33. Retaining Ring       |
| 4. Ball Bearings     | 14. O-Ring               | 24. Snap Rings     | 34. Clutch Break Disc    |
| 5. Splined Gear      | 15. O-Ring               | 25. Ball Bearing   | 35. Clutch Discs (3)     |
| 6. Snap Ring         | 16. Clutch Cup           | 26. Snap Ring      | 36. Separator Plates (2) |
| 7. Snap Ring         | 17. Belleville Washer    | 27. Thrust Washer  | 37. Piston Back Plate    |
| 8. Retaining Ring    | 18. Pressure Plate       | 28. Clutch Shaft   |                          |
| 9. Clutch Back Plate | 19. Bolt (3)             | 29. Woodruff Key   |                          |
| 10. Clutch Discs (3) | 20. Oil Seal             | 30. Low Drive Gear |                          |

TA must be completely removed from the tractor to install elimination coupler. After TA has been removed, clamp the TA shaft #28 into a soft jaw vise. Remove snap ring #7, then using a suitable puller, remove clutch pack #8 through #19 and #33 through #37 as an assembly. Remove woodruff key #29 from clutch shaft #28. Remove low drive gear #30 with sprag clutch #31 and oil seal #32. The front housing assembly #21 and #24 through #26 will remain on the shaft. Seal #20 should be replaced. Install snap ring #7 to shaft to hold coupler in place. Install shaft and casting assembly into tub, making sure to align coupler over upper direct drive gear #2. Pump and all pressure tubes and related hydraulic components must be reinstalled. Selector spool linkage can be disconnected. On 85 & C series tractors disconnect the wires to solenoid on the regulator control valve. On 84 series tractors with TA pump, remove pump gear.